



Enerquip Code 7 Single Round Filter Housings

When Schedule Counts

Overview

Enerquip's code 7 filter housings are offered in heights of 5" and 10" in the single round design configuration. These code 7 filter housings come with a recessed base design and an all 316L stainless steel construction on the product contact side. All housings come with a choice of internal surface finish and a choice of inlet, outlet, vent, and drain connections.

Features and Options

- T-Line and I-Line design available with recessed base design
- 316L product contact side construction
- 10" and 5" single round designs
- 32 Ra mechanical polish OD; 20 Ra Mechanical polish ID
- Factory pressure tested and passivated

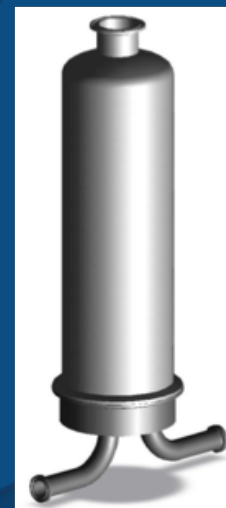

FILTER HOUSING STANDARD OFFERING

PART NUMBER	DESCRIPTION	FINISH	PRICE
5T75P150N	5" T-line Filter housing, .75" TC Inlet/Outlet, 1.5" TC gage port, Plunger drain valve, no vent	20 Ra	\$2,500
5T100P150N	5" T-line Filter housing, 1" TC Inlet/Outlet, 1.5" TC gage port, Plunger drain valve, no vent	20 Ra	\$2,525
10T100P150N	10" T-line Filter housing, 1" TC Inlet/Outlet, 1.5" TC gage port, Plunger drain valve, no vent	20 Ra	\$2,610
5I150P150N	5" I-line Filter Housing, 1.5" TC Inlet/Outlet, Plunger drain valve, no vent	20 Ra	\$2,075
10I150P150N	10" I-line Filter Housing, 1.5" TC Inlet/Outlet, Plunger drain valve, no vent	20 Ra	\$2,225

10" T-Line
Filter housing with .75" inlet and outlet connections and a 1.50" gage port. Includes a plunger valve on the outlet



FILTER HOUSING STANDARD OFFERING

PART NUMBER	DESCRIPTION	FINISH	PRICE
- EP	Optional Electropolish ID finish	15 Ra EP	\$300
- D	Optional Documentation to include: Mtr's, Weld Logs, Gasket COC's		\$480
	Customized inlets, outlets, vent and drain connections		TBD

10" T-Line
Filter housing with 1.50" inlet and outlet connections. Includes a plunger valve on the outlet and no accessory on the inlet.

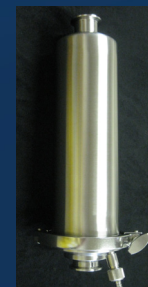

Sanitary Stainless Steel Membrane Housings



MODEL SELECTION GUIDE

